

# WILTON, NH

# MILFORD, NH

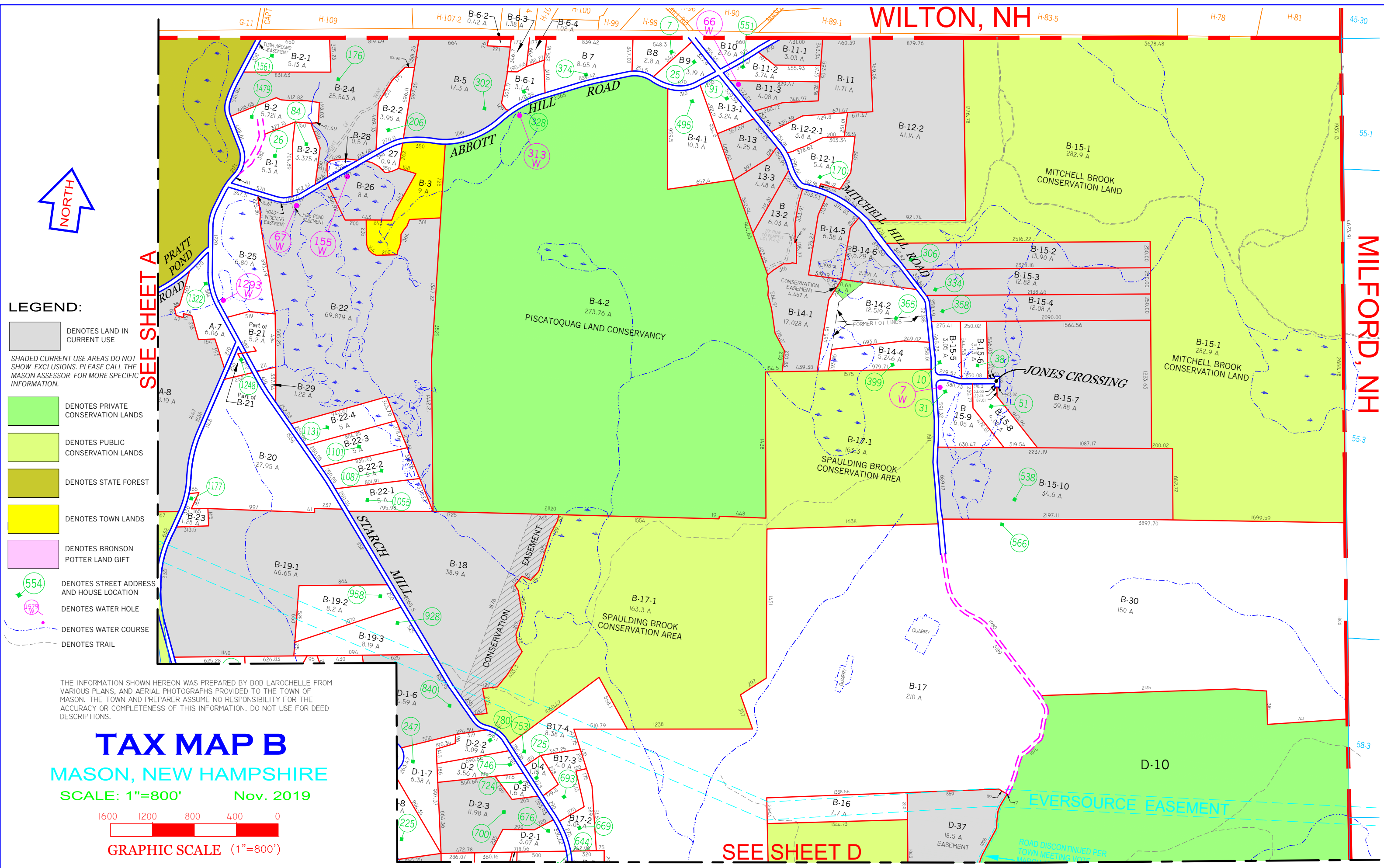

- LEGEND:**
- DENOTES LAND IN CURRENT USE
  - DENOTES PRIVATE CONSERVATION LANDS
  - DENOTES PUBLIC CONSERVATION LANDS
  - DENOTES STATE FOREST
  - DENOTES TOWN LANDS
  - DENOTES BRONSON POTTER LAND GIFT
  - 554 DENOTES STREET ADDRESS AND HOUSE LOCATION
  - 1579 W DENOTES WATER HOLE
  - DENOTES WATER COURSE
  - DENOTES TRAIL

SEE SHEET A

SEE SHEET D

THE INFORMATION SHOWN HEREON WAS PREPARED BY BOB LAROCHELLE FROM VARIOUS PLANS, AND AERIAL PHOTOGRAPHS PROVIDED TO THE TOWN OF MASON. THE TOWN AND PREPARER ASSUME NO RESPONSIBILITY FOR THE ACCURACY OR COMPLETENESS OF THIS INFORMATION. DO NOT USE FOR DEED DESCRIPTIONS.

## TAX MAP B

### MASON, NEW HAMPSHIRE

SCALE: 1"=800'      Nov. 2019

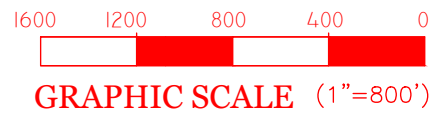

EVERSOURCE EASEMENT

ROAD DISCONTINUED PER TOWN MEETING

PRATT POND

HILL ROAD

ABBOTT HILL ROAD

MITCHELL HILL ROAD

JONES CROSSING

STARCH MILL

CONSERVATION EASEMENT

SPAULDING BROOK CONSERVATION AREA

EVERSOURCE EASEMENT

ROAD DISCONTINUED PER TOWN MEETING



PRATT POND

HILL ROAD

ABBOTT HILL ROAD

MITCHELL HILL ROAD

JONES CROSSING

STARCH MILL

CONSERVATION EASEMENT

SPAULDING BROOK CONSERVATION AREA

EVERSOURCE EASEMENT

ROAD DISCONTINUED PER TOWN MEETING

